

## Minarah College – Proposed new Catherine Field school

### ABOUT THE PROPOSAL

A new co-educational Kindergarten to Year 12 college is being proposed for the local community, with classrooms and facilities to be future-focused and purpose built to prepare students for jobs of the future.

Minarah College – Catherine Field would accommodate 1,580 students, including an Early Learning Centre, Special Education School, and OOSH care.

It will be an inclusive school welcoming all students and families from the community, and would be thrilled to have all local students to support diverse and rewarding community connections.

Minarah College will leverage the teaching and learning expertise of Green Valley Islamic College, which topped the 2020 list of best

performing schools in Liverpool based on NAPLAN results – opening as its second campus in this growing region.

New schools are urgently needed in the area, with the NSW Government estimating 77,978 student places are needed by 2036. Minarah College would be proud to meet a small fraction of this demand and would deliver the school in stages, in line with growth in the local community.

The new school represents a \$70 million investment in the local community, to be funded through bank loans. It would create 150 jobs during construction and 140 new full time/part time jobs once opened.

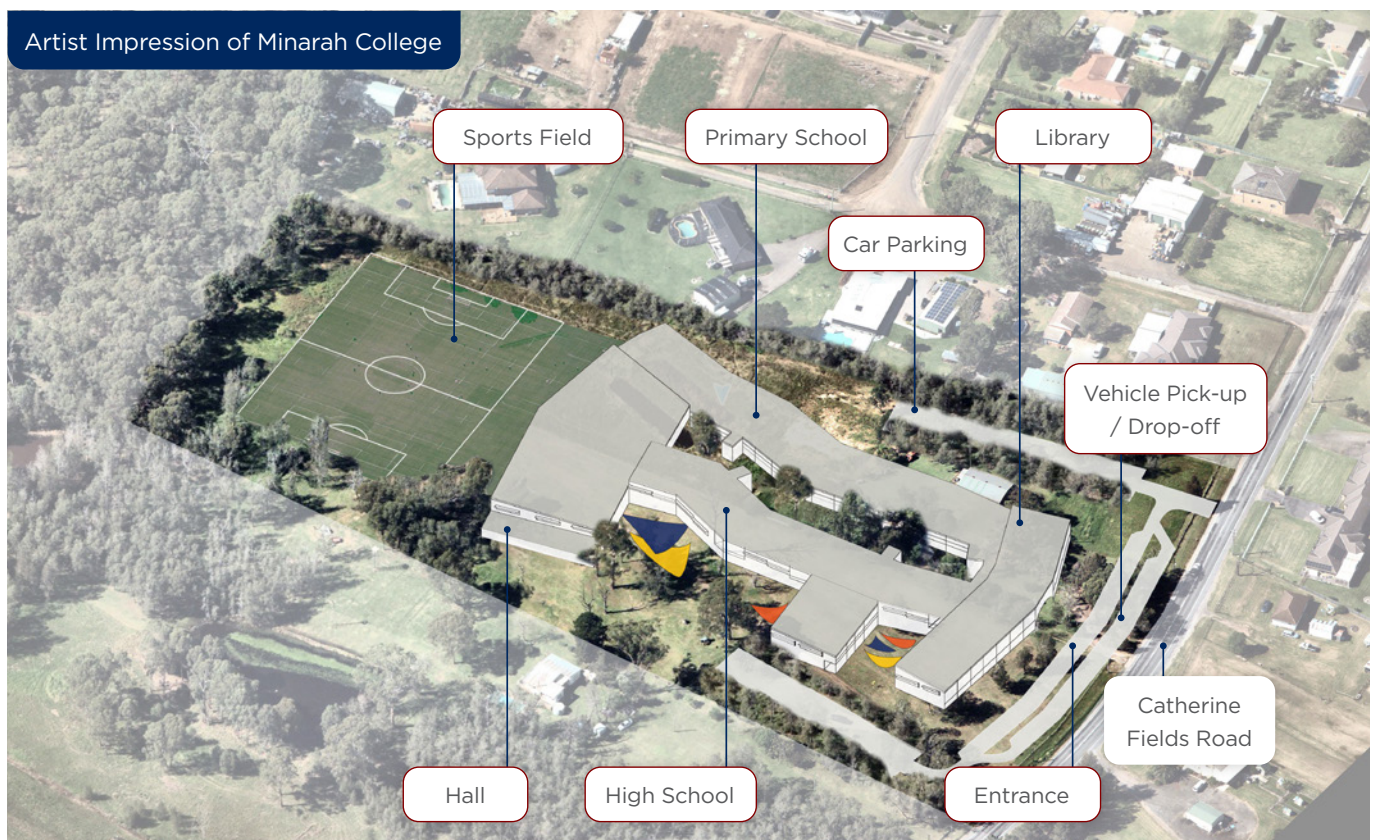

## A VALUABLE ADDITION TO THE LOCAL NEIGHBOURHOOD

Minarah College is committed to being a good neighbour. A number of design principles will be applied to ensure the school is a valuable addition to the local neighbourhood:

- School buildings will be designed to reflect local character, and native landscaping will be used to complement the semi-rural surrounds and preserve visual amenity for neighbours.
- School buildings will be sited well within the site boundaries so there will be no overshadowing on neighbouring properties.
- Provisions will be made to share access to new school facilities, such as sports fields, with the local community.
- The project will strive for the highest Green Star rating obtainable with the Green Building Council Australia, ensuring a positive contribution to local sustainability.

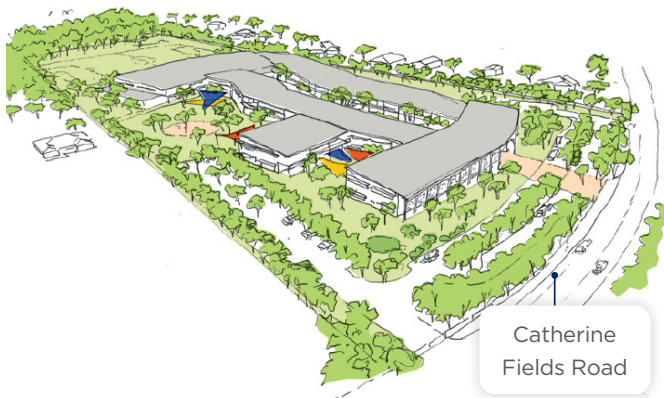

Artist impression of Minarah College - Catherine Field

## TRAFFIC AND PARKING

We recognise that our new school will generate new traffic movements on Catherine Fields Road and Deepfields Road, and we will do everything we can to reduce impacts for other road users.

All pick-ups and drop-offs by private vehicle and bus will be managed internal to the site. This means that queuing will occur within the school grounds, with minimal impact on surrounding streets. Best practice examples from other Sydney schools will be used to inform the design – some of these run so smoothly you would not know there was a school in the area at all.

There will also be staggered start and finish times for different year groups to spread drop-off and pick-ups.

Pick-up waiting areas for students will be positioned away from site boundaries to minimise noise for neighbours.

Getting traffic and parking right is important to us as we want to be good neighbours. We will undertake robust traffic and parking studies as part of our State Significant Development.

Our design and management plans will need to be able to demonstrate that vehicle movements generated by the school – both during construction and once opened – can be accommodated on the local road network.



## ENVIRONMENTAL MANAGEMENT

Environmental studies will be completed as part of our State Significant Development application. These will identify any potential impacts on the environment and outline how those impacts will be mitigated. They will cover biodiversity and protected species, bushfire, flooding and water management, air quality and emissions, noise, waste, heritage, and Aboriginal heritage.

Our site adjoins fairly dense native vegetation to the north and west. We will add native landscaping and vegetation to our site, including at these boundaries, to support a soft visual transition between us and our neighbours, and preserve visual amenity for neighbours and from the streetscape.

To allow for the school buildings, which will be located away from the site boundaries to reduce impacts on neighbours, a number of trees will need to be removed. Each of these trees (and more) will be replaced in key locations around the site to provide shaded play areas for students and maintain privacy for neighbours.

## CONSTRUCTION MANAGEMENT

Our approach to construction will involve the least amount of disruption to neighbours.

A draft Construction and Traffic Management Plan will be lodged as part of our State Significant Development application and this will outline mitigation measures that we would use. It will include things such as:

- Management of noise, dust and air quality.
- Management of construction vehicles.
- Construction hours, which would be advised by the Department of Planning, Industry and Environment and Council.
- Construction methodology, such as using some prefabricated structures, which would reduce the amount of activity on site.
- Channels for the community to contact the project team with any concerns during construction to ensure prompt resolution.

Prior to starting construction, we will engage with neighbours to keep them informed and minimise the impact of site activities as much as possible.

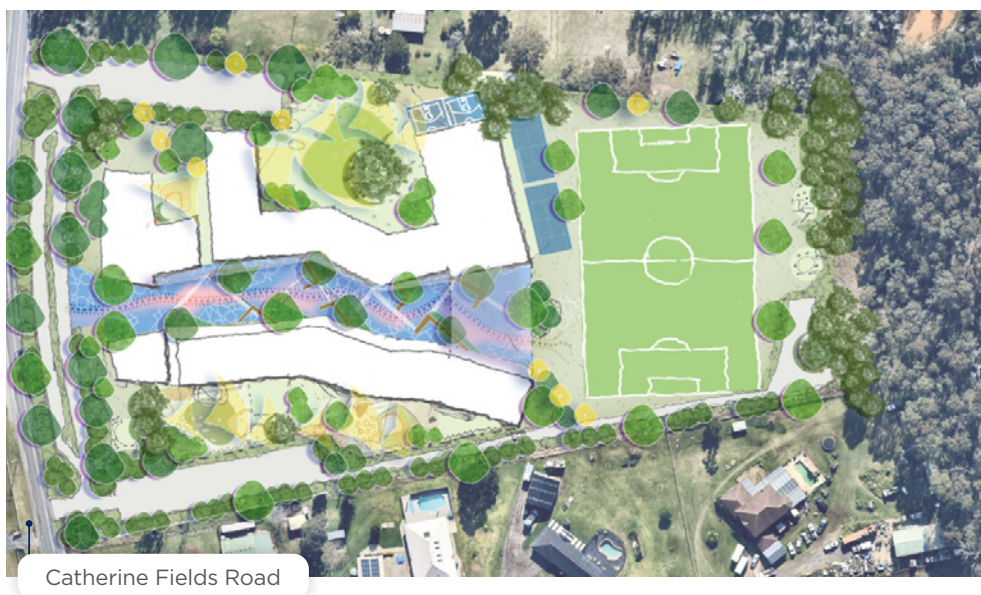

Landscape design

## **A COMPREHENSIVE PLANNING PROCESS**

This proposal is being assessed as a State Significant Development. This means a development application will be lodged with the Department of Planning, Industry and Environment. Camden Council is a key stakeholder in the process.

The next step in the planning process involves preparing a State Significant Development (SSD) application to the Department.

The application will contain specialist studies, which are an important part of the planning process and provide information to decision makers about the economic, environmental and social impacts of the project.

The specialist studies consider matters such as traffic, noise, operations, and construction management. They help the community, government agencies and the consent authority to make informed submissions or decisions on the merits of the project.

Community engagement is a valued part of the process and we welcome your comments.

## **NEXT STEPS**

**Thank you for taking the time to learn about Minarah College - Catherine Field.**

Your comments and questions about our proposal are most welcome. Please submit them by 24 November 2021 to [enquiries@minarahcollege.com.au](mailto:enquiries@minarahcollege.com.au) - that way your feedback can be considered as we prepare our State Significant Development application.

There will be another opportunity to review our application when the Department of Planning, Industry and Environment puts it on public exhibition. At this time, there will be more detailed information available to share as the planning and design process would be further progressed.

To stay up-to-date, visit [www.minarahcollege.com.au](http://www.minarahcollege.com.au)